



# AIR TORQUE

**AIR TORQUE S.p.A.**  
 via Alla Campagna, 1  
 24060 Costa di Mezzate (Bg) Italy  
 Tel.: +39 035 682299  
 Fax: +39 035 687791  
 E-mail: info@airtorque.it

**Tab. 00098 E**

Issued on: 03/06

## Fast Acting Actuators DA and SR 4thG. Operating time and Construction for models AT051 ÷ AT301

Construction:

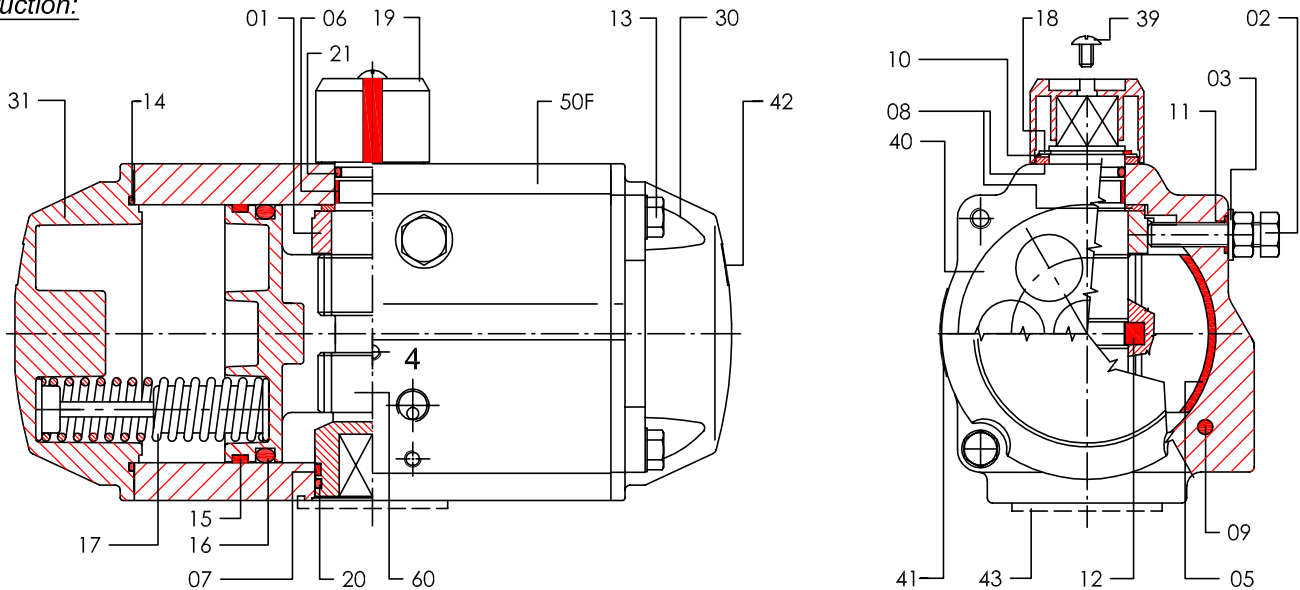

PART N°	UNIT Q.TY	PART DESCRIPTION	PART N°	UNIT Q.TY	PART DESCRIPTION
01	1	OCTI-CAM (Stop arrangement)	16*	2	"O" RING (Piston)
02	2	CAP SCREW	17	min. 5 / max. 12	SPRING (Cartridge)
03	2	WASHER	18	1	SPRING CLIP (Pinion)
04	2	NUT ( CAP SCREW)	19	1	POSITION INDICATOR
05*	2	BEARING (Piston back)	20*	1	"O" RING (Pinion bottom)
06*	1	BEARING (Pinion top)	21*	1	"O" RING (Pinion top)
07*	1	BEARING (Pinion bottom)	30	1	RIGHT END CAPS
08*	2	THRUST BEARING (Pinion)	31	1	LEFT END CAPS
09*	2	PLUG	39	1	CAP SCREW (Indicator)
10	1	THRUST WASHER (Pinion)	40	2	PISTON
11*	4	"O" RING (Stop screw)	41	1	ACTUATOR IDENTIFICATION LABEL
12	2	PISTON GUIDE	42	2	END CAP LABEL
13	8	CAP SCREW (End cap)	43	1	SPIGOT (Only on request)
14*	2	"O" RING (End cap)	<b>50F</b>	<b>1</b>	<b>SPECIAL BODY</b>
15*	2	BEARING (Piston head)	60	1	DRIVE SHAFT

\* Suggested SPARE PARTS for maintenance

Dimensions:

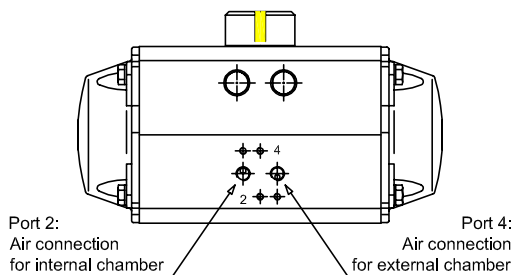

Technical Data and Test Conditions:

Technical Data:

ACTUATOR MODEL	AIR CONN. SIZE PORT 2	AIR CONN. SIZE PORT 4	AIR BORE (mm)		MINIMUM OPERATING TIME (sec.)			
			PORT 2	PORT 4	Double Acting		Spring Return	
					Opening	Closing	Opening	Closing
F AT051 D/S	G1/8"-ISO228	G1/8"-ISO228	ø4,5	ø4,5	0,04	0,06	0,07	0,08
F AT101 D/S	G1/8"-ISO228	G1/8"-ISO228	ø4,5	ø4,5	0,05	0,08	0,12	0,16
F AT201 D/S	G1/8"-ISO228	G1/8"-ISO228	ø5,5	ø4,5	0,07	0,10	0,18	0,22
F AT251 D/S	G1/8"-ISO228	G1/8"-ISO228	ø6	ø4,5	0,09	0,12	0,30	0,25
F AT301 D/S	G1/4"-ISO228	G1/4"-ISO228	ø7	ø5	0,18	0,23	0,40	0,35

Test Conditions:

The **MINIMUM** operating time indicated is obtained in the following test conditions:  
 (1) Room Temperature, (2) Actuator Stroke: 90°, (3) Minimum inside diameter for air supply circuit equal to air bore,  
 (7) Supply circuit without solenoid valve. (4) Medium: clean air, (5) Air supply pressure: 6 bar (80 Psi), (6) Actuator without external resistance load.

**Cautions: obviously on the field applications when one or more of the above parameters are different, the moving time will be different.**