



AIR TORQUE

AIR TORQUE S.p.A.
 via Alla Campagna, 1
 24060 Costa di Mezzate (Bg) Italy
 Tel.: +39 035 682299
 Fax: +39 035 687791
 E-mail: info@airtorque.it

Tab. 00099 E

Issued on: 02/07

Fast Acting Actuators DA and SR 4thG. Operating time and Construction for models AT351 ÷ AT1000

Construction:

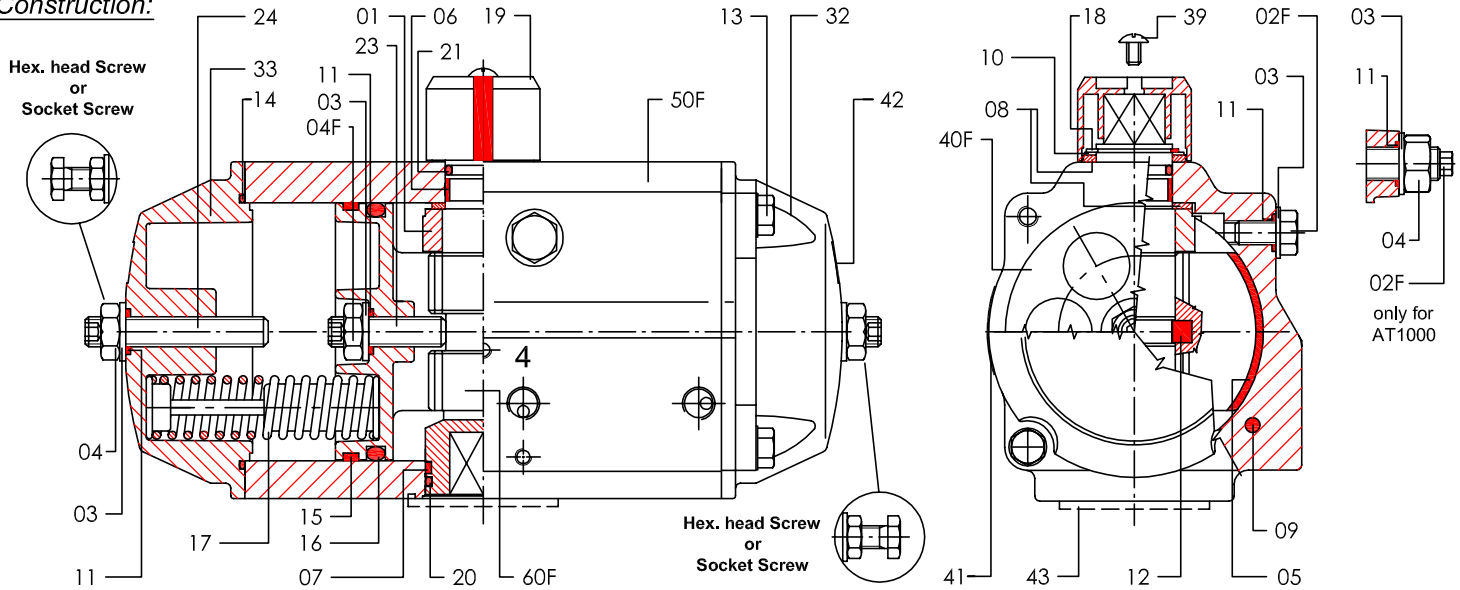

Dimensions:

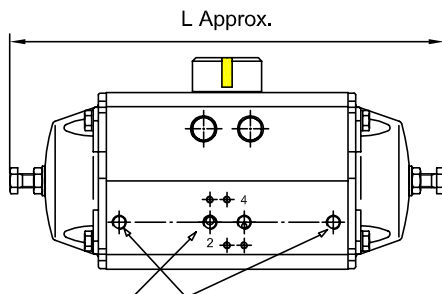

Port 2:
 Air connection
 for internal chamber

Extra air connections for
 external chambers
 - NOT APPLICABLE FOR
 MODEL AT801 AND AT1000

- Air supply holes for DA
 - Exhaust air holes for SR
 (filter only on request)

PART N°	UNIT Q.TY	PART DESCRIPTION	PART N°	UNIT Q.TY	PART DESCRIPTION
01 (C)	1	OCTI-CAM (Stop arrangement)	16*	2	"O" RING (Piston)
02F	2	CAP SCREW	17	min. 5 / max. 12	SPRING (Cartridge)
03	6	WASHER	18	1	SPRING CLIP (Pinion)
04 (C)	2	NUT (SCREW EXT. STROKE ADJ.)	19	1	POSITION INDICATOR
04F (C)	2	NUT (SCREW INT. STROKE ADJ.)	20*	1	"O" RING (Pinion bottom)
05* (C)	2	BEARING (Piston back)	21*	1	"O" RING (Pinion top)
06*	1	BEARING (Pinion top)	23	2	SCREW (INT. STROKE ADJ.)
07*	1	BEARING (Pinion bottom)	24	2	SCREW (EXT. STROKE ADJ.)
08*	2	THRUST BEARING (Pinion)	32 (B)	1	RIGHT END CAPS (THREADED)
09*	2	PLUG	33 (B)	1	LEFT END CAPS (THREADED)
10	1	THRUST WASHER (Pinion)	39	1	CAP SCREW (Indicator)
11*	6	"O" RING (Stop screw)	40F	2	PISTON
12	2	PISTON GUIDE	41	1	ACTUATOR IDENTIFICATION LABEL
13	8 (A)	CAP SCREW (End cap)	42	2	END CAP LABEL
14*	2	"O" RING (End cap)	43	1	SPIGOT (Only on request)
15*	2	BEARING (Piston head)	50F	1	BODY
			60F	1	DRIVE SHAFT

* Suggested SPARE PARTS for maintenance
(A) 12 pcs. for model AT701, 16 pcs. for model AT801 and AT1000
(B) For models AT551 and bigger the 2 End Cap are symmetric
(C) for model AT1000: 8 pcs. Part n°04, 4 pcs. Part n°05, Not Applicable Part. n° 01 and n° 04F.

Stroke adjustment:

- at 90° (fully open position) stroke adjustment through screw ext. stroke adj. part n°24 on the END-CAPS.
- at 0° (fully closed position) stroke adjustment through screw int. stroke adj. part n°23 on the PISTONS.

Technical Data and Test Conditions:

Technical Data:

ACTUATOR MODEL	L max. approx. (mm)
AT351 D/S	385
AT401 D/S	414
AT451 D/S	498
AT501 D/S	507
AT551 D/S	584
AT601 D/S	625
AT651 D/S	716
AT701 D/S	852
AT801 D/S	1000
AT1000 D/S	1100

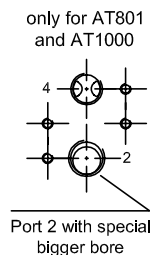

ACTUATOR MODEL	AIR CONN. SIZE PORT 2	EXTRA AIR CONNECTION	AIR BORE (mm)		MINIMUM OPERATING TIME (sec.)			
			PORT 2	EXTRA AIR CONN.	Double Acting		Spring Return	
					Opening	Closing	Opening	Closing
F AT351 D/S	G 1/4"-ISO228	G1/4"-ISO228	ø9	ø8	0,06	0,09	0,15	0,20
F AT401 D/S	G 1/4"-ISO228	G1/4"-ISO228	ø9	ø8	0,07	0,10	0,20	0,25
F AT451 D/S	G 1/4"-ISO228	G1/4"-ISO228	ø10	ø10	0,09	0,12	0,22	0,28
F AT501 D/S	G 1/4"-ISO228	G1/4"-ISO228	ø10	ø10	0,15	0,23	0,28	0,35
F AT551 D/S	G 3/8"-ISO228	G3/8"-ISO228	ø12	ø12	0,20	0,30	0,32	0,40
F AT601 D/S	G 3/8"-ISO228	G3/8"-ISO228	ø12	ø12	0,25	0,35	0,38	0,45
F AT651 D/S	G 1/2"-ISO228	G1/2"-ISO228	ø13	ø13	0,30	0,40	0,46	0,55
F AT701 D/S	G 1/2"-ISO228	G1/2"-ISO228	ø15	ø15	0,35	0,45	0,52	0,60
F AT801 D/S	G 3/4"-ISO228	NA	ø20	NA	0,40	0,50	1,00	1,30
F AT1000 D/S	G 1"-ISO228	NA	ø21	NA			1,50	1,40

Test Conditions:

The **MINIMUM** operating time indicated is obtained in the following test conditions:

- (1) Room Temperature, (2) Actuator Stroke: 90°, (3) Minimum inside diameter for air supply circuit equal to air bore,
- (4) Supply circuit without solenoid valve, (5) Medium: clean air, (6) Air supply pressure: 6 bar (87 Pst), (6) Actuator without external resistance load.

Cautions: obviously on the field applications when one or more of the above parameters are different, the moving time will be different.