



AIR TORQUE

AIR TORQUE S.p.A.
 via Alla Campagna, N° 1
 24060 Costa di Mezzate (Bg) Italy
 Tel.: +39 035 682299
 Fax: +39 035 687791
 E-mail: info@airtorque.it

T.D.S. n° U00102E

Issued on: 02/10 - Page 1/1

4thG Upgrade Actuators construction suitable for EXTREME LOW TEMPERATURE LLT from -55°C (-67°F) to +80°C (+176°F)

Material Construction:

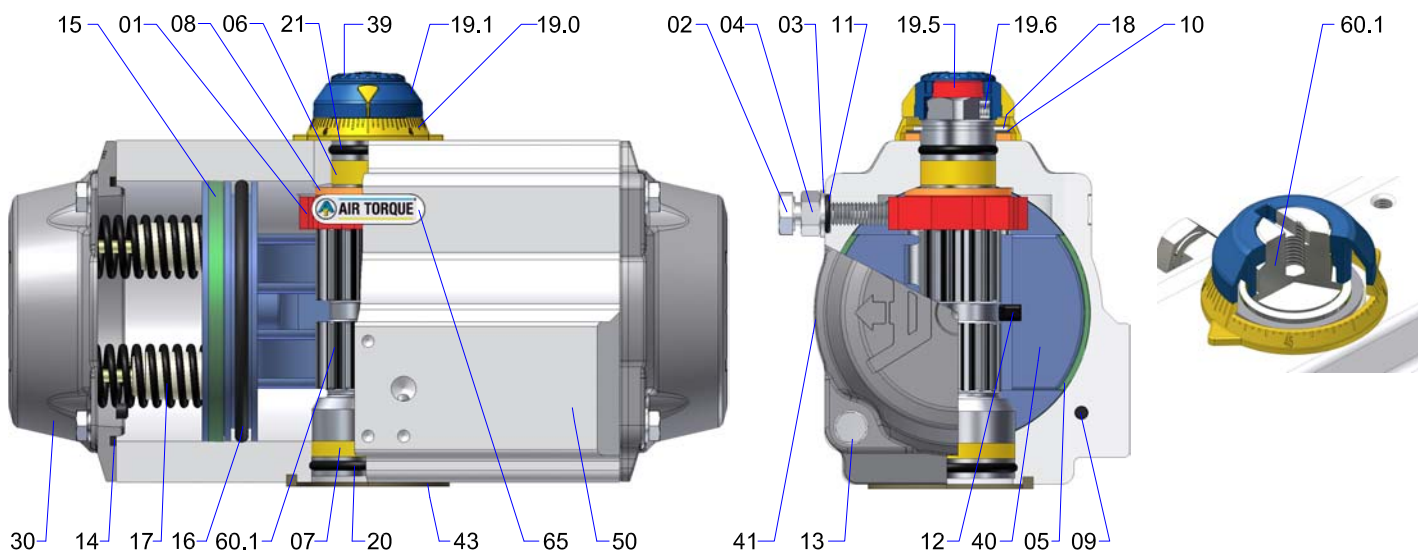

PART N°	UNIT Q.TY / NOTE	PART DESCRIPTION	STANDARD MATERIAL / CORROSION PROTECTION
01	1 NA for AT045U	OCTI-CAM (Stop arrangement)	Stainless Steel (only for AT051U ÷ AT301U) Carbon Steel / Nodular Cast Iron, zinc coated
02	2 NA for AT045U	STOP CAP SCREW	Stainless Steel A2 70 (ISO 3506)
03	2 NA for AT045U	WASHER	Stainless Steel A2 (ISO 3506)
04	2 NA for AT045U	NUT (Stop screw)	Stainless Steel A2 70 (ISO 3506)
05*	2 4 pcs. for AT1001U	BEARING (Piston back)	PA46
06*	1 for AT045U ÷ AT101U for AT201U ÷ AT1001U	BEARING (Pinion top)	PA46 HGP
07*	1 for AT045U ÷ AT101U for AT201U ÷ AT1001U	BEARING (Pinion bottom)	PA46 HGP
08*	2 1 pcs. for model AT045U for AT045U ÷ AT751U	THRUST BEARING (Pinion)	PA46
09*	2 for AT801U ÷ AT1001U	PLUG	Silicone
09*	2	"O-RING" PLUG	Special Silicone
10	1	THRUST WASHER (Pinion)	Stainless Steel AISI 304
11*	2 NA for AT045 U	"O" RING (Stop screw)	Special Silicone
12	2	PISTON GUIDE	PA66+GF
13	8 for AT045U ÷ AT651U 12 for AT701U and AT751U 16 for AT801U and AT1001U	CAP SCREW (End cap)	Stainless Steel A2 70 (ISO 3506)
13.1	16 for AT1001U	WASHER (Cap Screw end cap)	Stainless Steel A2 (ISO 3506)
14*	2	"O" RING (End cap)	Special Silicone
15*	2	BEARING (Piston head)	POM
16*	2	"O" RING (Piston)	Special Silicone
17	max. 12 for AT101U ÷ AT1001U	SPRING (Cartridge)	SiCr Spring alloy Steel coated
17.1	max. 2 for AT045U ÷ AT051U	SPRING	SiCr Spring alloy Steel coated
17.2	max. 2 for AT045U ÷ AT051U	SPRING	SiCr Spring alloy Steel coated
17.3	max. 2 for AT045U ÷ AT051U	SPRING	SiCr Spring alloy Steel coated
18	1	SPRING CLIP (Pinion)	Stainless Steel AISI 302
19	1 for AT045U ÷ AT101U	POSITION INDICATOR	PA66+GF+CB / Stainless Steel
19.0	1	GRADUATED RING	PA66+GF+CB
19.1	1 NA for AT045U ÷ AT101U	POSITION INDICATOR	PA66+GF+CB
19.5	1 NA for AT045 U / only for AT1001U	TOP ADAPTOR	Extruded Aluminium alloy, anodized
19.6	2 NA for AT045 U / only for AT1001U	HEX. SOCKET SCREW (Top Adaptor)	Stainless Steel
20*	1	"O" RING (Pinion bottom)	Special Silicone
21*	1	"O" RING (Pinion top)	Special Silicone
30	2 for AT045U ÷ AT751U for AT801U and AT1001U	END CAP	Pressure Die Cast Aluminium alloy, anodized and coated Cast Aluminium alloy, anodized and coated
39	1	CAP SCREW (Indicator)	PA66+GF+CB
40	2 for AT045 U ÷ AT751 U for AT801 U and AT1001 U	PISTON	Pressure Die Cast Aluminium alloy, anodized Cast Aluminium alloy, anodized
41	1	ACTUATOR IDENTIFICATION LABEL	Polyester-Silver
42	2 only for model AT045U, AT801U e AT1001U	END CAP LABEL	Polyester-Silver
43	1	SPIGOT (Only on request)	Extruded Aluminium alloy, anodized
50	1 for AT801U and AT1001U	BODY	Extruded Aluminium alloy, coated Cast Aluminium alloy, coated
60	1 only for model AT045U and AT1001U	DRIVE SHAFT	Extruded Aluminium alloy, anodized
60.1	1 for AT051U ÷ AT801U	INTEGRAL DRIVE SHAFT	Stainless Steel AISI 316 (1,4401), E.N.P.
65	1	PLASTIC INSERT	PA66 Modified

Notes:

* Suggested SPARE PARTS for maintenance.

- Lubricant: GLLT GREASE

- For operation installation and maintenance see our AIR TORQUE manual of instruction for use and maintenance IMAT 4thG.

Technical Data:

• Operating temperature: -55°C (-67°F) ÷ +80°C (+176°F) / UP TO -60°C (-76°F) ONLY FOR SHORT PERIOD OF TIME.

• Operating time: to be verified on each application depending on working conditions.

• Working pressure: max. 8 bar.

• Operating Media: dry or lubricated air or inert/non-corrosive gases provided they are compatible with internal actuator parts and lubricant.

The operating media must have a dew point equal at least 10 °C below the ambient temperature. The maximum particle size must not exceed 30 µm.